

Replacement Parts List

Notes: *Important safety notice:
 Components identified by Δ mark have special characteristics important for safety.
 Furthermore, special parts which have purposes of fire-retardant (resistors), high-quality sound (capacitors), low-noise (resistors), etc. are used.
 When replacing any of components, be sure to use only manufacturer's specified parts shown in the parts list.
 *All parts are supplied by MESA.

Ref. No.	Part No.	Part Name & Description	Pcs	Remarks	Ref. No.	Part No.	Part Name & Description	Pcs	Remarks
1	RKM0202E-H	CABINET	1		C132	ECBT1H102KB5	50V 1000P	1	
2	RHD30007-K1	SCREW	4		C133, 34	ECBT1H270JU5	50V 27P	2	
3	XTBS3+10JFZ1	SCREW	1		C136	ECBT1H102KB5	50V 1000P	1	
4	RGW0183-H	KNOB, VOLUME	1		C137	ECFR1E472KR	25V 4700P	1	
5	RKA0011-3	FOOT	4		C138	ECBT1C103K5S	16V 0.01U	2	
5-1	SHG1645	RUBBER	1		C139	ECFR1E472KR	25V 4700P	1	
6	RKQ0089-2	PCB SPACER	6		C141, 42	ECEA1HKA010B	50V 1U	2	
7	RMN0203	PCB HOLDER 1	1		C143, 44	ECBT1C472KR5	16V 4700P	2	
8	RFKGAEH500EH	FRONT PANEL ASS'Y	1	(E, EB)	C147	ECBT1H102KB5	50V 1000P	1	
8	RFKGAEH500EG	FRONT PANEL ASS'Y	1	(EG, EP)	C148	ECBT1C103NS5	16V 0.01U	1	
9	RMN0427	CABLE HOLDER	1		C149	ECBT1H104ZF5	50V 0.1U	1	
10	XTBS3+8JFZ1	SCREW	2		C151	RCE1CKA100BG	16V 10U	1	(EG, EP)
11	RMN0426	FL HOLDER	1		C152	ECBT1H331KB5	50V 330P	1	(EG, EP)
12	RMN0429	PCB HOLDER 2	1		C154	ECBT1H561KB5	50V 560P	1	(EG, EP)
13	RMN0437	PCB HOLDER 3	1		C155	ECBT1H102KB5	50V 1000P	1	(EG, EP)
14	REZ1088	FLAT CABLE ASS'Y	1		C156, 57	ECBT1H470J5	50V 47P	2	(EG, EP)
15	REZ0983	FLAT CABLE ASS'Y	1		C158, 59	ECEA0JKA470B	6.3V 47U	2	(EG, EP)
16	REZ1076	WIRE ASS'Y	1		C160	ECBT1H102KB5	50V 1000P	1	(EG, EP)
17	RLBT4001-D	FERRITE CORE (5P)	1		C201, 02	ECBT1H180J5	50V 18P	2	
18	REX0852	WIRE ASS'Y	1		C219-26	ECBT1H101KB5	50V 100P	8	
19	RGK0894-N	ORNAMENT	1		C229-34	ECBT1H101KB5	50V 100P	6	
20	XTW3+15T	SCREW	4		C235	ECBT1H104ZF5	50V 0.1U	1	
21	XTB3+8JFZ	SCREW	6		C236, 37	ECBT1H102KB5	50V 1000P	2	
22	RHD26016	SCREW	1		C301	ECBT1H102KB5	50V 1000P	1	
23	RHN90001	NUT	1		C302, 03	ECBT1H561KB5	50V 560P	2	
24	RKW0506B-Q	FL PANEL	1		C309	ECEA1HKAR22B	50V 0.22U	1	
25	XTB3+10JFZ	SCREW	9		C310	ECFR1C823MR	16V 0.082U	1	
26	XTB3+20JFZ	SCREW	5		C312	ECFR1C823MR	16V 0.082U	1	
27	XTBS26+8J	SCREW	5		C313	ECFR1C103KR	16V 0.01U	1	
A1	RAK-CH426WH	REMOTE CONTROL TRANSMITTER	1		C315	ECFR1C223KR	16V 0.022U	1	
A1-1	RKK0080-K	BATTERY COVER	1		C316	ECBT1C332KR5	16V 3300P	1	
A2	REE0499	SPEAKER CORD	2		C318	ECBT1C682KR5	16V 6800P	1	
A3	REE0853	SPEAKER CORD	2		C319	ECBT1H102KB5	50V 1000P	1	
A4	RJA0019-X	AC POWER CORD	1	(E, EG, EP)	C320	ECBT1H681KB5	50V 680P	1	
A4	RJA0053-1X	AC POWER CORD	1	(EB)	C321	ECBT1C332KR5	16V 3300P	1	
A5	RQA0117	GUARANTY CORD	1	(E, EB, EG)	C322	ECQV1H154JM3	50V 0.15U	1	
A6	RQT4299-E	OPERATION INSTRUCTIONS	1	(E) <IA>	C324	RCE1CKA100BG	16V 10U	1	
A6	RQT4300-D	OPERATION INSTRUCTIONS	1	(EG) <IB>	C325	ECQV1H154JM3	50V 0.15U	1	
A6	RQT4301-H	OPERATION INSTRUCTIONS	1	(EG) <IC>	C326	ECBT1H102KB5	50V 1000P	1	
A6	RQT4302-B	OPERATION INSTRUCTIONS	1	(EB, EP) <ID>	C327	ECBT1H471KB5	50V 470P	1	
A6	RQT4303-R	OPERATION INSTRUCTIONS	1	(EP) <IE>	C328	RCE1CKA470BG	16V 47U	1	
A7	RSA0007	FM INDOOR ANTENNA	1		C329	ECEA1CKA220B	16V 22U	1	
A8	RSA0022-J	AM LOOP ANTENNA	1		C330	ECBT1H681KB5	50V 680P	1	
A9	RQCA0597	QUICK REFERENCE GUIDE	1	(EB)	C331	ECBT1H104ZF5	50V 0.1U	1	
A10	SJP9009	D1N ADAPTOR	1	(EB)	C332-34	ECBT1H470J5	50V 47P	3	
A11	RQCBD169	SERVICE CENTER LIST	1	(E, EB, EG)	C336	ECBT1H104ZF5	50V 0.1U	1	
C101	ECBT1C103NS5	16V 0.01U	1		C337	RCE1CKA470BG	16V 47U	1	
C102	ECEA1CKA101B	16V 100U	1		C338	ECBT1H471KB5	50V 470P	1	
C103	ECBT1C103NS5	16V 0.01U	1		C339	ECBT1H102KB5	50V 1000P	1	
C104, 05	ECBT1H102KB5	50V 1000P	2		C340	ECQV1H154JM3	50V 0.15U	1	
C106	ECBT1C103NS5	16V 0.01U	1		C341	RCE1CKA100BG	16V 10U	1	
C107	ECBT1H473ZF5	50V 0.47U	1		C342	ECQV1H154JM3	50V 0.15U	1	
C108	ECBT1H8R2K5	50V 8.2P	1		C343	ECEA1CKA220B	16V 22U	1	
C109	ECBT1H102KB5	50V 1000P	1		C344	ECBT1C332KR5	16V 3300P	1	
C110	ECBT1C103NS5	16V 0.01U	1		C346	ECBT1H102KB5	50V 1000P	1	
C111	ECEA1EKA4R7B	25V 4.7U	1		C347	ECBT1C682KR5	16V 6800P	1	
C112	ECBT1C103NS5	16V 0.01U	1		C349	ECBT1C332KR5	16V 3300P	1	
C113	ECBT1H102KB5	50V 1000P	1		C350	ECFR1C223KR	16V 0.022U	1	
C114	RCE1HKA3R3BG	50V 3.3U	1		C352	ECFR1C103KR	16V 0.01U	1	
C115	ECEA1EKA4R7B	25V 4.7U	1		C353	ECFR1C823MR	16V 0.082U	1	
C116	ECFR1C333KR	16V 0.033U	1		C355	ECFR1C823MR	16V 0.082U	1	
C117, 18	ECFR1C183KR	16V 0.018U	2		C356	ECEA1HKAR22B	50V 0.22U	1	
C119	ECQP1391JZ3	100V 390P	1		C357, 58	ECQV1H104JM3	50V 0.1U	2	
C120	RCE1CKA100BG	16V 10U	1		C359	RCE1HKA3R3BG	50V 3.3U	1	
C121	RCE1HKAR47BG	50V 0.47U	1		C360	RCE1HKA4R7BG	50V 4.7U	1	
C122, 23	ECEA1HKA010B	50V 1U	2		C364	ECBT1C152KR5	16V 1500P	1	
C124	ECBT1H101KB5	50V 100P	1		C365	ECQV1H154JM3	50V 0.15U	1	
C125	ECEA1CKA220B	16V 22U	1		C372	ECBT1H104ZF5	50V 0.1U	1	
C126	ECBT1H473ZF5	50V 0.47U	1		C385, 86	RCE1CKA100BG	16V 10U	2	
C127	ECEA1CKA220B	16V 22U	1		C395, 96	ECBT1H473ZF5	50V 0.47U	2	
C129, 30	ECEA0JKA101B	6.3V 100U	2		C501-06	ECBT1H101KB5	50V 100P	6	
C131	ECBT1H101KB5	50V 100P	1		C507, 08	RCE1CKA100BG	16V 10U	2	
					C509-12	ECBT1E103ZF5	25V 0.01U	4	
					C515	ECEA1CKA330B	16V 33U	1	
					C550	ECBT1E103ZF5	25V 0.01U	1	

Ref.No.	Part No.	Part Name & Description	Pcs	Remarks	Ref.No.	Part No.	Part Name & Description	Pcs	Remarks
C551	ECEA1HKA2R2B	50V 2.2U	1		C913	RCE1CKA100BG	16V 10U	1	
C552	ECBT1E103ZF5	25V 0.01U	1		C914	ECEA1HKA2R2B	50V 2.2U	1	
C553	ECEA1HKA68B	50V 0.68U	1		C915	ECBT1E103ZF5	25V 0.01U	1	
C554	ECA1AM221B	10V 220U	1		C916	ECA0JKF101B	6.3V 100U	1	
C604, 05	RCE1CKA100BG	16V 10U	2		C917	ECBT1E103ZF5	25V 0.01U	1	
C607, 08	ECBT1C122KR5	16V 1200P	2		C918	ECEA0JKA221B	6.3V 220U	1	
C613, 14	ECBT1H150JC5	50V 15P	2		C919, 20	ECEA1HKS2R2B	50V 2.2U	2	
C615	ECEA2AUD10B	100V 1U	1		C921	ECBT1H102KB5	50V 1000P	1	
C616	ECA1JM330B	63V 33U	1		C922	ECEA1VKA330B	35V 33U	1	
C617	ECEA1HKNR47B	50V 0.47U	1		C1101, 02	ECBT1H473ZF5	50V 0.047U	2	
C618	ECA1HM101B	50V 100U	1		C1103-06	ECBT1H102KB5	50V 1000P	4	
C620, 21	ECQV1H473JM3	50V 0.047U	2		C1113, 14	ECBT1H473ZF5	50V 0.047U	2	
C631, 32	ECBT1H102KB5	50V 1000P	2						
C633	ECBT1C103KS5	16V 0.01U	1		CF201	RLFFETNGD01L	CERAMIC FILTER	1	
C655	ECEA2AU3R3B	100V 3.3U	1		CF202	RLFFETMGD01L	CERAMIC FILTER	1	
C656	ECBT1E103ZF5	25V 0.01U	1						
C657	ECBT1H104ZF5	50V 0.1U	1		CN101B, 2B	RJU100W07	CONNECTOR (7P)	2	
△ C701, 02	ECA1VHG472E	35V 4700U	2		CN201	RJU057W010	CONNECTOR (10P)	1	
△ C703, 04	ECA1VHG332E	35V 3300U	2		CN203	RJU057W012	CONNECTOR (12P)	1	
C705	RCE1CKA100BG	16V 10U	1		CN601	SJT30943-V	CONNECTOR (9P)	1	
C706	RCE1VKA100BG	35V 10U	1		CN701-09	RJS1A1101T1	CONNECTOR (1P)	9	
C707	ECBT1E103ZF5	25V 0.01U	1		CN711-13	RJS1A1101T1	CONNECTOR (1P)	3	
C708	RCE1CKA100BG	16V 10U	1		CN715	RJU057W012	CONNECTOR (12P)	1	
C709	ECBT1H104ZF5	50V 0.1U	1		CN721	SJT30943-V	CONNECTOR (9P)	1	
C710	ECBT1E103ZF5	25V 0.01U	1		CN722	SJT30443-V	CONNECTOR (4P)	1	
C711	RCE1EM471B	25V 470U	1		CN802	RJU057W008	CONNECTOR (8P)	1	
C714	ECBT1H102KB5	50V 1000P	1		CN803	RJU057W007	CONNECTOR (7P)	1	
△ C715	ECA1EM472E	25V 4700U	1		CN904	RJS4T7ZA	CONNECTOR (4P)	1	
C717	ECEA1CKA330B	16V 33U	1						
C718	RCE1AKA101BG	10V 100U	1		CP101B, 2B	RJT100W07	CONNECTOR (7P)	2	
C719, 20	ECBT1E103ZF5	25V 0.01U	2		CP201	RJT057W010-1	CONNECTOR (10P)	1	
C721	RCE1AKA101BG	10V 100U	1		CP203	RJT057W012-1	CONNECTOR (12P)	1	
C723	ECBT1E103ZF5	25V 0.01U	1		CP715	RJT057W012-1	CONNECTOR (12P)	1	
C725	RCE1CKA100BG	16V 10U	1		CP802	RJT057W008-1	CONNECTOR (8P)	1	
C726	ECBT1E103ZF5	25V 0.01U	1		CP803	RJT057W007-1	CONNECTOR (7P)	1	
C731	ECBT1H102KB5	50V 1000P	1						
C732	ECBT1E223ZF5	25V 0.022U	1		△ D101	MA4051MTA	DIODE	1	
C733	ECBT1E103ZF5	25V 0.01U	1		D151	MA4051MTA	DIODE	1	(EG, EP)
C734	RCE1CKA100BG	16V 10U	1		D331	MA4051LTA	DIODE	1	
△ C736	ECA1EM101B	25V 100U	1		△ D515	MA4140MTA	DIODE	1	
△ C737, 38	ECA1HM101B	50V 100U	2		D551, 52	MA165	DIODE	2	
△ C739	ECA1JM101B	63V 100U	1		D555	MA4100MTA	DIODE	1	
C740	RCE1CKA100BG	16V 10U	1		D558	MA165	DIODE	1	
C741	ECBT1H104ZF5	50V 0.1U	1		D601, 02	SB360L6508	DIODE	2	
C751, 52	ECA1AM471B	16V 470U	2		△ D651	MA4180LTA	DIODE	1	
C753	ECBT1H101KB5	50V 100P	1		△ D652, 53	MA4140MTA	DIODE	2	
C761	ECQE1104KF3	100 0.1U	1		D657, 58	MA165	DIODE	2	
C810	ECBT1E103ZF5	25V 0.01U	1		△ D701-04	1N5402BF	DIODE	4	
C819	ECBT1E103ZF5	25V 0.01U	1		△ D705-08	RL1N4003N02	DIODE	4	
C822, 23	ECBT1H101KB5	50V 100P	2		D709	MA165	DIODE	1	
C838, 39	ECBT1H101KB5	50V 100P	2		D710	MA4051MTA	DIODE	1	
C849, 50	RCE1CKA100BG	16V 10U	2		D711	RL1N4003N02	DIODE	1	
C853	ECQV1H473JM3	50V 0.047U	1		△ D713, 14	MA185TA	DIODE	2	
C854	ECQV1H683JM3	50V 0.068U	1		D715	MA165	DIODE	1	
C855	ECQV1H473JM3	50V 0.047U	1		△ D717-20	RL1N4003N02	DIODE	4	
C856	ECQV1H683JM3	50V 0.068U	1		△ D721	MA4300MTA	DIODE	1	
C859, 60	ECBT1H101KB5	50V 100P	2		△ D723	MA4150M	DIODE	1	
C875	ECQV1H823JM3	50V 0.082U	1		△ D725	MA4082LTA	DIODE	1	
C876	ECEA1CKA330B	16V 33U	1		△ D727	MA4062-H	DIODE	1	
C879	ECFR1C683KR	16V 0.068U	1		△ D730	MA4100MTA	DIODE	1	
C880	ECFR1C333KR	16V 0.033U	1		D732-36	MA165	DIODE	5	
C881	ECQV1H154JM3	50V 0.15U	1		△ D737	MA4082LTA	DIODE	1	
C884	ECQV1H104JM3	50V 0.1U	1		D738, 39	MA165	DIODE	2	
C885	ECBT1C472KR5	16V 4700P	1		△ D751, 52	1N5402BF	DIODE	2	
C886	ECBT1H101KB5	50V 100P	1		△ D753-55	RL1N4003N02	DIODE	3	
C890	ECEA1AKA220B	10V 22U	1		D803-05	MA165	DIODE	3	
C891, 92	RCE1AKA470BG	10V 47U	2		D901, 02	1SS291TA	DIODE	2	
C901	ECBT1H104ZF5	50V 0.1U	1		D903, 04	MA165	DIODE	2	
C902	ECA0JW102	6.3V 1000U	1		D905	1SS291TA	DIODE	1	
C903, 04	ECBT1E103ZF5	25V 0.01U	2		D906, 07	MA165	DIODE	2	
C905-08	ECBT1H471KB5	50V 470P	4		D908	LNJ301MPPJAD	LED	1	
C909	ECBT1H102KB5	50V 1000P	1		D909, 10	MA165	DIODE	2	
C910	ECBT1H150JC5	50V 15P	1		D933	MA165TA	DIODE	1	(EG, EP)
C911	ECBT1H180J5	50V 18P	1		D934	MA165	DIODE	1	
C912	ECBT1H104ZF5	50V 0.1U	1		D936	MA165	DIODE	1	

Ref.No.	Part No.	Part Name & Description	Pcs	Remarks
D943, 44	MA165	DIODE	2	
D971, 72	MA165	DIODE	2	
△ D973	MA4039MTA	DIODE	1	
D974	MA165	DIODE	1	
E601	SNE1004-2	EARTH TERMINAL	1	
E603	SNE1004-2	EARTH TERMINAL	1	
△ F1	XBA2C12TB0	FUSE, T1. 25A	1	
FC1, C2	EYF52BC	FUSE HOLDER	2	
FL901	RSL0251-F	DISPLAY TUBE	1	
IC101	LA1833MN-TLM	IC	1	
IC102	LC72131MDTLM	IC	1	
IC151	LC72721M-TLM	IC	1	(EG, EP)
IC301	M62433AFP	IC	1	
IC501	M5218AP	IC	1	
△ IC601	RSN308M24	IC	1	
IC802	M5228FPE1	IC	1	
IC804	M5228FPE1	IC	1	
IC901	M38199MF107K	IC	1	
JK101	RJHS210W	ANTENNA	1	
JK201	RJT065K19	SYSTEM	1	
JK203	SJF3068-7N	VCR IN	1	
JK204	SJF3069-5N	VDP/VCR OUT	1	
JK501	RJRO054B	SPEAKERS	1	
JK503	RJRO054C	SPEAKERS	1	
△ JK701	SJS9236	AC INLET	1	
JK903	RJJ37TN01-C	HEADPHONES	1	
L101, 02	ELESNR68MA	COIL	2	
L103	ELETR47MA9	COIL	1	
L151, 52	ELEXT101KA9	COIL	2	(EG, EP)
L601, 02	RLQYR73MW1-0	COIL	2	
△ L701	RLQZ271M-K	COIL	1	
L901	RLQA100JT-Y	COIL	1	
P1	RPF0139	POLYETHYLENE COVER	1	
P2	RPG3514	PACKING CASE (SH/SL-EH500)	1	
P2	RPG3515	PACKING CASE (RS-EH600)	1	
P2	RPG3517	PACKING CASE (SA-EH500)	1	
P3	RPG3859	PACKING CASE (SYSTEM)	1	(E)
P3	RPG3860	PACKING CASE (SYSTEM)	1	(EP)
P3	RPG3941	PACKING CASE (SYSTEM)	1	(EG)
P3	RPG3942	PACKING CASE (SYSTEM)	1	(EB)
P4	RPN1037	PAD (RS-EH600)	1	
P4	RPN1038	PAD (SH/SL-EH500)	1	
P4	RPN1117	PAD (SA-EH500)	1	
P5	RPQ0769	SPACER	1	
P6	RPQ0770	SPACER	1	
P7	SPP740	SHEET	1	
Q101, 02	2SC2787L	TRANSISTOR	2	
Q106	UN4111	TRANSISTOR	1	
Q110	2SC3311AR	TRANSISTOR	1	
Q305, 06	2SD1450STA	TRANSISTOR	2	
Q307, 08	2SD2144STA	TRANSISTOR	2	
Q309, 10	UN4115TA	TRANSISTOR	2	
Q503	2SD1450STA	TRANSISTOR	1	
Q551	2SA1995RSTA	TRANSISTOR	1	
Q554	2SA1995RSTA	TRANSISTOR	1	
Q555	2SD2144STA	TRANSISTOR	1	
Q605	2SC5398RSTA	TRANSISTOR	1	
△ Q651	2SB1238QRTV2	TRANSISTOR	1	
Q652	2SD1859QRTV2	TRANSISTOR	1	
Q654	2SD1859QRTV2	TRANSISTOR	1	
Q656	2SC5398RSTA	TRANSISTOR	1	
△ Q701	2SD2374PQAU	TRANSISTOR	1	
△ Q702	2SB1548PQAU	TRANSISTOR	1	
△ Q703	2SD2374PQAU	TRANSISTOR	1	
Q704	UN4211TA	TRANSISTOR	1	
Q705	2SA1995RSTA	TRANSISTOR	1	

Ref.No.	Part No.	Part Name & Description	Pcs	Remarks
△ Q707	2SB621AQRSTA	TRANSISTOR	1	
△ Q708	2SD2137PQTA	TRANSISTOR	1	
Q709	2SD2144STA	TRANSISTOR	1	
Q711	2SB1417PQTA	TRANSISTOR	1	
△ Q712	2SB1548PQAU	TRANSISTOR	1	
Q718	UN4111	TRANSISTOR	1	
Q719, 20	2SD1450STA	TRANSISTOR	2	
Q721	2SC3311AIRTA	TRANSISTOR	1	
Q722	2SA1309AIRTA	TRANSISTOR	1	
△ Q723	2SC3940AQSTA	TRANSISTOR	1	
Q724	UN4211TA	TRANSISTOR	1	
△ Q725	2SC5398RSTA	TRANSISTOR	1	
Q808-10	2SD1450STA	TRANSISTOR	3	
Q812, 13	UN4115TA	TRANSISTOR	2	
Q814	UN4211TA	TRANSISTOR	1	
Q901	UN4214TA	TRANSISTOR	1	
Q902-04	2SC3311AIRTA	TRANSISTOR	3	
Q906	UN411FTA	TRANSISTOR	1	
R102	ERDS2FJ472	1/4W 4.7K	1	
R103	ERDS2FJ101	1/4W 100	1	
R104	ERDS2FJ103	1/4W 10K	1	
R105	ERDS2TJ471T	1/4W 470	1	
R106	ERDS2FJ474	1/4W 470K	1	
R107	ERDS2TJ331T	1/4W 330	1	
R108	ERDS2FJ474	1/4W 470K	1	
R109	ERDS2TJ331T	1/4W 330	1	
R110	ERDS2FJ102	1/4W 1K	1	
R111	ERDS2TJ391T	1/4W 390	1	
R112	ERDS2FJ104	1/4W 100K	1	
R113	ERDS2FJ103	1/4W 10K	1	
R114	ERDS2FJ562	1/4W 5.6K	1	
R115	ERDS2TJ561T	1/4W 560	1	
R116	ERDS2FJ102	1/4W 1K	1	
R117	ERDS2TJ683T	1/4W 68K	1	
R118	ERDS2FJ472	1/4W 4.7K	1	
R119	ERDS2TJ333T	1/4W 33K	1	
R120	ERDS2TJ473T	1/4W 47K	1	
R121	ERDS2TJ223T	1/4W 22K	1	
R122	ERDS2FJ272	1/4W 2.7K	1	
R123	ERDS2TJ683T	1/4W 68K	1	
R124	ERDS2TJ271T	1/4W 270	1	
R125, 26	ERDS2TJ152T	1/4W 1.5K	2	
R127	ERDS2TJ471T	1/4W 470	1	
R128	ERDS2TJ820T	1/4W 82	1	
R129	ERDS2TJ273T	1/4W 27K	1	
R130	ERDS2FJ103	1/4W 10K	1	
R131	ERDS2FJ680	1/4W 68	1	
R132	ERDS2FJ103	1/4W 10K	1	
R133-37	ERDS2FJ102	1/4W 1K	5	
R138	ERDS2FJ103	1/4W 10K	1	
R139	ERDS2TJ332T	1/4W 3.3K	1	
R140	ERDS2FJ472	1/4W 4.7K	1	
R141, 42	ERDS2FJ102	1/4W 1K	2	
R143	ERDS2TJ223T	1/4W 22K	1	
R145, 46	ERDS2FJ104	1/4W 100K	2	
R151, 52	ERDS2TJ102T	1/4W 1K	2	(EG, EP)
R153, 54	ERDS2TJ104T	1/4W 100K	2	(EG, EP)
R155	ERDS2TJ121T	1/4W 120	1	(EG, EP)
R158, 59	ERDS2TJ102T	1/4W 1K	2	(EG, EP)
R201, 02	ERDS2FJ752	1/4W 7.5K	2	
R217, 18	ERDS2FJ562	1/4W 5.6K	2	
R221, 22	ERDS2FJ752	1/4W 7.5K	2	
R223, 24	ERDS2FJ562	1/4W 5.6K	2	
R225, 26	ERDS2FJ104	1/4W 100K	2	
R227, 28	ERDS2FJ222	1/4W 2.2K	2	
R229, 30	ERDS2FJ102	1/4W 1K	2	
R231, 32	ERDS2FJ103	1/4W 10K	2	
R233, 34	ERDS2FJ682	1/4W 6.8K	2	
R235, 36	ERDS2FJ102	1/4W 1K	2	
R239-42	ERDS2FJ102	1/4W 1K	4	
R243, 44	ERDS2TJ152T	1/4W 1.5K	2	
R245, 46	ERDS2TJ332T	1/4W 3.3K	2	
R249, 50	ERDS2FJ101	1/4W 100	2	
R251	ERDS2FJ222	1/4W 2.2K	1	

Ref.No.	Part No.	Part Name & Description	Pcs	Remarks	Ref.No.	Part No.	Part Name & Description	Pcs	Remarks
R252	ERDS2FJ103	1/4W 10K	1		R713, 14	ERDS2TJ332T	1/4W 3.3K	2	
R253, 54	ERDS2FJ104	1/4W 100K	2		R715	ERDS2FJ183	1/4W 18K	1	
R255, 56	ERDS2TJ123T	1/4W 12K	2		R717	ERDS2TJ473T	1/4W 47K	1	
R257, 58	ERDS2FJ562	1/4W 5.6K	2		R719	ERDS2TJ332T	1/4W 3.3K	1	
R261, 62	ERDS2FJ1R0	1/4W 1	2		R720	ERDS2FJ272	1/4W 2.7K	1	
R301	ERDS2TJ223T	1/4W 22K	1		△ R721	ERD2FCJ4R7	1/4W 4.7	1	
R302	ERDS2FJ472	1/4W 4.7K	1		△ R722	ERQ16NKW2R2E	1/6W 2.2	1	
R303, 04	ERDS2FJ222	1/4W 2.2K	2		R723	ERDS2FJ562	1/4W 5.6K	1	
R305, 06	ERDS2FJ102	1/4W 1K	2		R724	ERDS2TJ152T	1/4W 1.5K	1	
R307, 08	ERDS2FJ104	1/4W 100K	2		R725	ERDS2TJ100T	1/4W 10	1	
R309, 10	ERDS2FJ102	1/4W 1K	2		R727	ERDS2TJ152T	1/4W 1.5K	1	
R311, 12	ERDS2FJ104	1/4W 100K	2		R729	ERDS2TJ221T	1/4W 220	1	
R313, 14	ERDS2TJ121T	1/4W 120	2		△ R735	ERQ16NKW2R2E	1/6W 2.2	1	
R315	ERDS2FJ104	1/4W 100K	1		R736	ERDS2FJ102	1/4W 1K	1	
R316	ERDS2FJ222	1/4W 2.2K	1		R737	ERDS2TJ221T	1/4W 220	1	
R317	ERDS2FJ105	1/4W 1M	1		R738	ERDS2FJ392	1/4W 3.9K	1	
R318	ERDS2TJ153T	1/4W 15K	1		R739	ERDS2TJ473T	1/4W 47K	1	
R323	ERDS2FJ272	1/4W 2.7K	1		R748	ERDS2FJ102	1/4W 1K	1	
R324	ERDS2TJ223T	1/4W 22K	1		R749	ERDS2TJ271T	1/4W 270	1	
R325	ERDS2FJ272	1/4W 2.7K	1		R751-54	ERDS2FJ4R7	1/4W 4.7	4	
R326	ERDS2TJ332T	1/4W 3.3K	1		△ R755	ERDS1FJ8R2	1/2W 8.2	1	
R327	ERDS2FJ392	1/4W 3.9K	1		△ R756	ERDS1FJ4R7	1/2W 4.7	1	
R328	ERDS2TJ332T	1/4W 3.3K	1		R757-59	ERDS2FJ103	1/4W 10K	3	
R329	ERDS2FJ103	1/4W 10K	1		R761, 62	ERDS2TJ822T	1/4W 8.2K	2	
R330	ERDS2TJ332T	1/4W 3.3K	1		R763	ERDS2FJ472	1/4W 4.7K	1	
R331	ERDS2FJ102	1/4W 1K	1		R764	ERDS2TJ331T	1/4W 330	1	
R332-34	ERDS2FJ222	1/4W 2.2K	3		△ R765	ERDS1FJ561	1/2W 560	1	
R335, 36	ERDS2TJ333T	1/4W 33K	2		R766	ERDS2FJ102	1/4W 1K	1	
R338	ERDS2FJ392	1/4W 3.9K	1		△ R767	ERD2FCJ4R7	1/4W 4.7	1	
R343	ERDS2TJ334T	1/4W 330K	1		R768	ERDS2FJ101	1/4W 100	1	
R344, 45	ERDS2FJ392	1/4W 3.9K	2		△ R791, 92	RSFMB30KT-L	PROTECTOR	2	
R360	ERDS2TJ223T	1/4W 22K	1		R803, 04	ERDS2TJ153T	1/4W 15K	2	
R364	ERDS2FJ103	1/4W 10K	1		R805	ERDS2TJ433T	1/4W 43K	1	
R365	ERDS2TJ223T	1/4W 22K	1		R806	ERDS2TJ333T	1/4W 33K	1	
R371, 72	ERDS2TJ100T	1/4W 10	2		R807	ERDS2TJ153T	1/4W 15K	1	
R380	ERDS2TJ153T	1/4W 15K	1		R809, 10	ERDS2TJ223T	1/4W 22K	2	
R501, 02	ERDS2FJ102	1/4W 1K	2		R811	ERDS2FJ103	1/4W 10K	1	
R503, 04	ERDS2TJ333T	1/4W 33K	2		R812	ERDS2TJ153T	1/4W 15K	1	
R505, 06	ERDS2FJ103	1/4W 10K	2		R813, 14	ERDS2TJ223T	1/4W 22K	2	
R507, 08	ERDS2TJ332T	1/4W 3.3K	2		R815, 16	ERDS2TJ473T	1/4W 47K	2	
R509-12	ERDS2FJ101	1/4W 100	4		R817	ERDS2TJ332T	1/4W 3.3K	1	
△ R515	ERGS1J102	1W 1K	1		R818	ERDS2TJ153T	1/4W 15K	1	
R551	ERDS2FJ183	1/4W 18K	1		R820	ERDS2TJ274T	1/4W 270K	1	
R552	ERDS2TJ473T	1/4W 47K	1		R821	ERDS2TJ822T	1/4W 8.2K	1	
R555	ERDS2TJ223T	1/4W 22K	1		R824	ERDS2FJ823	1/4W 82K	1	
R556	ERDS2FJ104	1/4W 100K	1		R828	ERDS2FJ823	1/4W 82K	1	
R557	ERDS2FJ103	1/4W 10K	1		R829, 30	ERDS2TJ223T	1/4W 22K	2	
R558	ERDS2FJ102	1/4W 1K	1		R831	ERDS2FJ392	1/4W 3.9K	1	
R559	ERDS2FJ472	1/4W 4.7K	1		R832	ERDS2TJ182T	1/4W 1.8K	1	
R561	ERDS2FJ104	1/4W 100K	1		R833, 34	ERDS2FJ104	1/4W 100K	2	
R562	ERDS2FJ102	1/4W 1K	1		R839, 40	ERDS2FJ102	1/4W 1K	2	
R570	ERDS2TJ335T	1/4W 3.3M	1		R841	ERDS2FJ103	1/4W 10K	1	
R591	ERDS2FJ472	1/4W 4.7K	1		R871, 72	ERDS2FJ105	1/4W 1M	2	
R604, 05	ERDS2FJ682	1/4W 6.8K	2		R876	ERDS2FJ224	1/4W 220K	1	
R619, 20	ERDS2TJ563T	1/4W 56K	2		R877, 78	ERDS2FJ472	1/4W 4.7K	2	
R623	ERDS2TJ684T	1/4W 680K	1		R879	ERDS2FJ562	1/4W 5.6K	1	
R624	ERDS2TJ223T	1/4W 22K	1		R889	ERDS2TJ152T	1/4W 1.5K	1	
R628	ERDS2FJ184	1/4W 18K	1		R893	ERDS2FJ103	1/4W 10K	1	
R629, 30	ERDS2TJ100T	1/4W 10	2		R894	ERDS2TJ153T	1/4W 15K	1	
R631	ERDS2FJ224	1/4W 220K	1		R901	ERDS2TJ821T	1/4W 820	1	
R632	ERDS2TKF5362	1/4W 53.6K	1		R902	ERDS2FJ102	1/4W 1K	1	
R633	ERDS2TKG5622	1/4W 56.2K	1		R903	ERDS2TJ122T	1/4W 1.2K	1	
R637	ERDS2TJ154T	1/4W 150K	1		R904	ERDS2TJ152T	1/4W 1.5K	1	
R638	ERDS2TJ684T	1/4W 680K	1		R905	ERDS2TJ182T	1/4W 1.8K	1	
△ R639-42	ERDS1FJ100	1/2W 10	4		R906	ERDS2FJ222	1/4W 2.2K	1	
△ R647, 48	ERD25FVJ2R2T	1/4W 2.2	2		R907	ERDS2FJ272	1/4W 2.7K	1	
R651	ERDS2FJ272	1/4W 2.7K	1		R908	ERDS2FJ472	1/4W 4.7K	1	
R654	ERDS2FJ272	1/4W 2.7K	1		R909	ERDS2FJ682	1/4W 6.8K	1	
R655, 56	ERDS2FJ183	1/4W 18K	2		R910	ERDS2TJ123T	1/4W 12K	1	
R667	ERDS2TJ331T	1/4W 330	1		R911	ERDS2TJ223T	1/4W 22K	1	
R701, 02	ERDS2TJ273T	1/4W 27K	2		R912	ERDS2TJ821T	1/4W 820	1	
R703, 04	ERDS2FJ101	1/4W 100	2		R919-23	ERDS2FJ103	1/4W 10K	5	
△ R707	ERDS2FJ4R7	1/4W 4.7	1		R924-27	ERDS2FJ102	1/4W 1K	4	
R708	ERDS2FJ472	1/4W 4.7K	1		R929	ERDS2FJ102	1/4W 1K	1	
R712	ERDS2TJ152T	1/4W 1.5K	1		R930	ERDS2FJ101	1/4W 100	1	

Ref.No.	Part No.	Part Name & Description	Pcs	Remarks
R931-36	ERDS2FJ102	1/4W 1K	6	
R937	ERDS2FJ562	1/4W 5.6K	1	
R938	ERDS2FJ102	1/4W 1K	1	
R939	ERDS2TJ152T	1/4W 1.5K	1	
R940, 41	ERDS2FJ102	1/4W 1K	2	
R942	ERDS2FJ101	1/4W 100	1	
R944	ERDS2TJ223T	1/4W 22K	1	
R946	ERDS2FJ102	1/4W 1K	1	
R947, 48	ERDS2FJ104	1/4W 100K	2	(E, EB)
R949	ERDS2FJ472	1/4W 4.7K	1	
R950	ERDS2FJ101	1/4W 100	1	
R951	ERDS2TJ334T	1/4W 330K	1	
R952	ERDS2TJ106T	1/4W 10M	1	
R953	ERDS2FJ101	1/4W 100	1	
R954	ERDS2FJ104	1/4W 100K	1	
R955	ERDS2TJ824T	1/4W 820K	1	
R956-58	ERDS2FJ102	1/4W 1K	3	
R959	ERDS2TJ471T	1/4W 470	1	
R960	ERDS2TJ152T	1/4W 1.5K	1	
R961, 62	ERDS2TJ223T	1/4W 22K	2	
R963, 64	ERDS2FJ103	1/4W 10K	2	
R965	ERDS2FJ472	1/4W 4.7K	1	
R966	ERDS2FJ103	1/4W 10K	1	
R967	ERDS2TJ473T	1/4W 47K	1	
R968	ERDS2FJ103	1/4W 10K	1	
R969, 70	ERDS2FJ472	1/4W 4.7K	2	
R971	ERDS2TJ473T	1/4W 47K	1	
R972	ERDS2TJ223T	1/4W 22K	1	
R974	ERDS2FJ101	1/4W 100	1	
R976	ERDS2TJ223T	1/4W 22K	1	
R977-81	ERDS2FJ104	1/4W 100K	5	
R984, 85	ERDS2TJ473T	1/4W 47K	2	
R986-88	ERDS2FJ102	1/4W 1K	3	
R989, 90	ERDS2FJ393	1/4W 39K	2	
R991	ERDS2TJ473T	1/4W 47K	1	
R993, 94	ERDS2FJ104	1/4W 100K	2	
R996, 97	ERDS2TJ151T	1/4W 150	2	
△ RL701	RSY0030-C	RELAY	1	
S901-12	EVQPTD05Q	SW	12	
S913, 14	EVQ21405R	SW	2	(EG, EP)
△ T501	RTP1V5B009-W	POWER TRANSFORMER	1	
VR901	EVQVBXFK124B	VR	1	
X102	RLFDT18DD	OSCILLATOR	1	
X103	RSXC7M20S05T	OSCILLATOR	1	
X151	RSXC4M33S02T	OSCILLATOR	1	(EG, EP)
X901	EF0EC6004T4	OSCILLATOR	1	
X902	RSXD32K7S02	OSCILLATOR	1	
Z101	RLA2Z003M-T	COMPONENT COMBINATION	1	
Z102	RL12Z006M-T	COMPONENT COMBINATION	1	
Z120	RAL0035	FM FRONT END	1	
Z901	RCDGP1U28XD	REMOTE SENSOR	1	

The "<IA> <IB> <IC> <ID> <IE>" marks in Remarks indicate language of instruction manual.

- <IA> : French, Spanish, Swedish
- <IB> : German, Italian, Danish
- <IC> : Dutch
- <ID> : English
- <IE> : Russian, Polish, Czech

■ Cabinet Parts Location

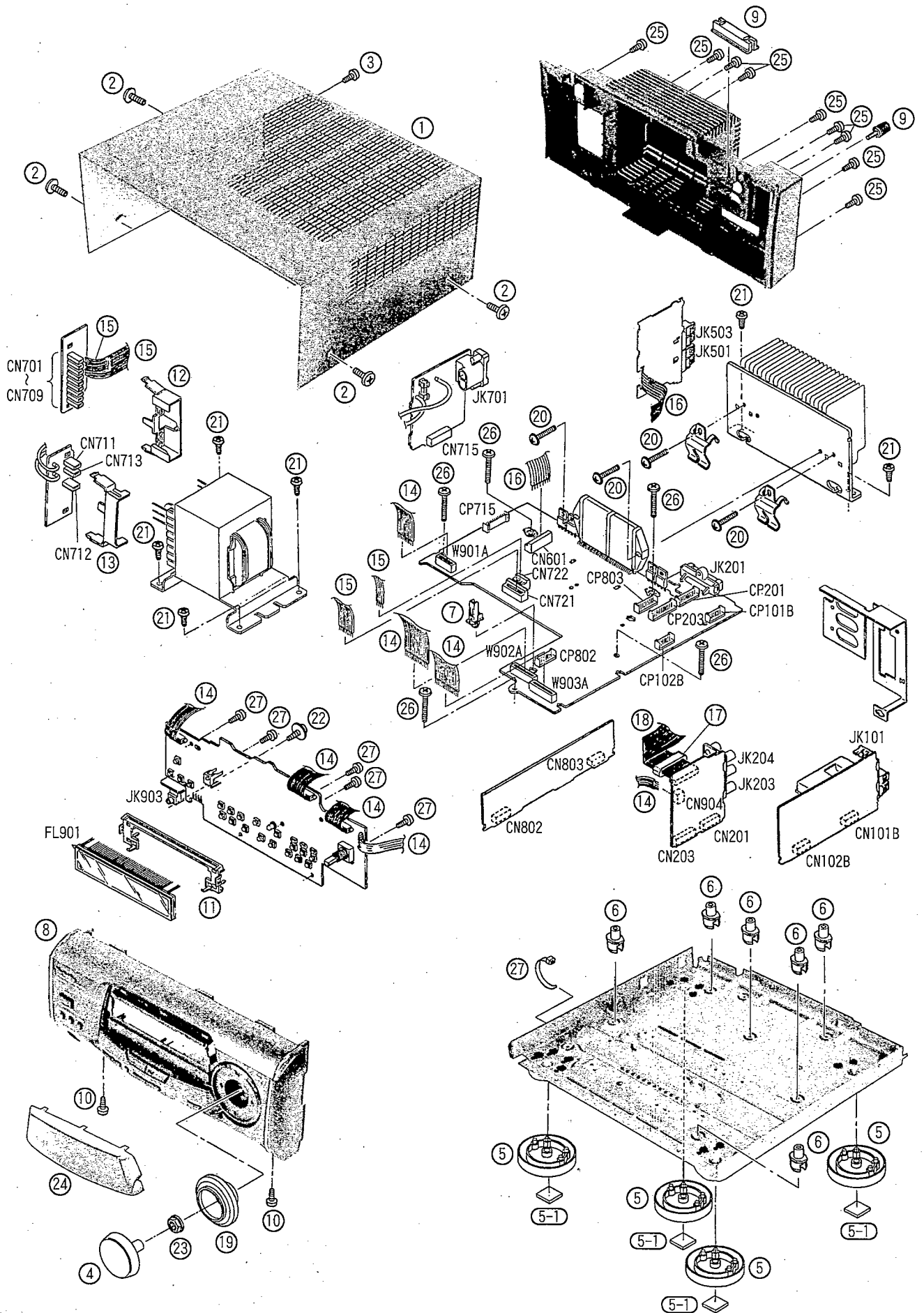

■ Packaging

903

